

An architectural rendering of a modern urban development. The central focus is a tall, multi-story building with a textured, grey facade and a grid of windows. To its right is a curved building with a glass facade and green balconies. The foreground shows a paved plaza with people walking, roller skating, and a small garden area with plants. The sky is blue with some clouds.

FALCON

RED BANK
RIVERSIDE

CLUBHOUSE



YOUR WINDOW TO A NEW KIND OF CITY LIVING

DISCOVER THE BEST OF MANCHESTER IN THE
EXCITING NEW RESIDENTIAL NEIGHBOURHOOD
OF RED BANK. FALCON'S ONE-, TWO- AND
THREE-BEDROOM HOMES COMBINE THE EASE
OF LIVING MINUTES FROM THE CITY CENTRE
WITH RESIDENTS' CLUBHOUSE AND NATURE
ON YOUR DOORSTEP.



Red Bank Terraces

MAKE NATURE YOUR NEIGHBOUR



Just a short walk from Victoria Station, Red Bank has been designed for a healthier city life, bringing nature into the heart of Manchester via the new City River Park. Winding through the neighbourhood, this dynamic green space promises unrivalled connection to the outdoors and unlimited possibilities for an active lifestyle.

Red Bank offers you the benefits of a well-connected, inner city neighbourhood with a thriving sense of community. On-your-doorstep convenience and big city amenities complement a bustling high street and inviting public spaces. This is a place for discovery, where neighbours can become friends.

RED BANK





URBAN RENEWAL ON AN UNPRECEDENTED SCALE

- 15,000 NEW HOMES ACROSS 155 HECTARES
- JOINT VENTURE WITH MANCHESTER CITY COUNCIL
- OVER £1 BILLION TOTAL INVESTMENT
- £51.6 MILLION CENTRAL GOVERNMENT INVESTMENT
- A NEW 113-ACRE CITY RIVER PARK
- A PLANNED NEW COMMUNITY OF OVER 40,000 PEOPLE WITH NEW SCHOOLS, HEALTHCARE FACILITIES AND TRANSPORT LINKS

Red Bank is one of seven neighbourhoods in Victoria North, the biggest urban renewal project Manchester has ever seen. In a city so popular that demand outstrips supply, the district will create 15,000 new homes—over 5,000 in Red Bank alone—and transport links for easy access into the city and beyond.

As one of the first buildings in Victoria North, Falcon will make owners pioneers of this groundbreaking new development—a joint venture with FEC and Manchester City Council. It puts retail, social and green spaces a short walk or cycle from home and work, making it an unmissable proposition for residents and a smart choice for investors.



MANCHESTER CITY CENTRE

ONE COMMUNITY, THREE DISTINCT NEIGHBOURHOODS

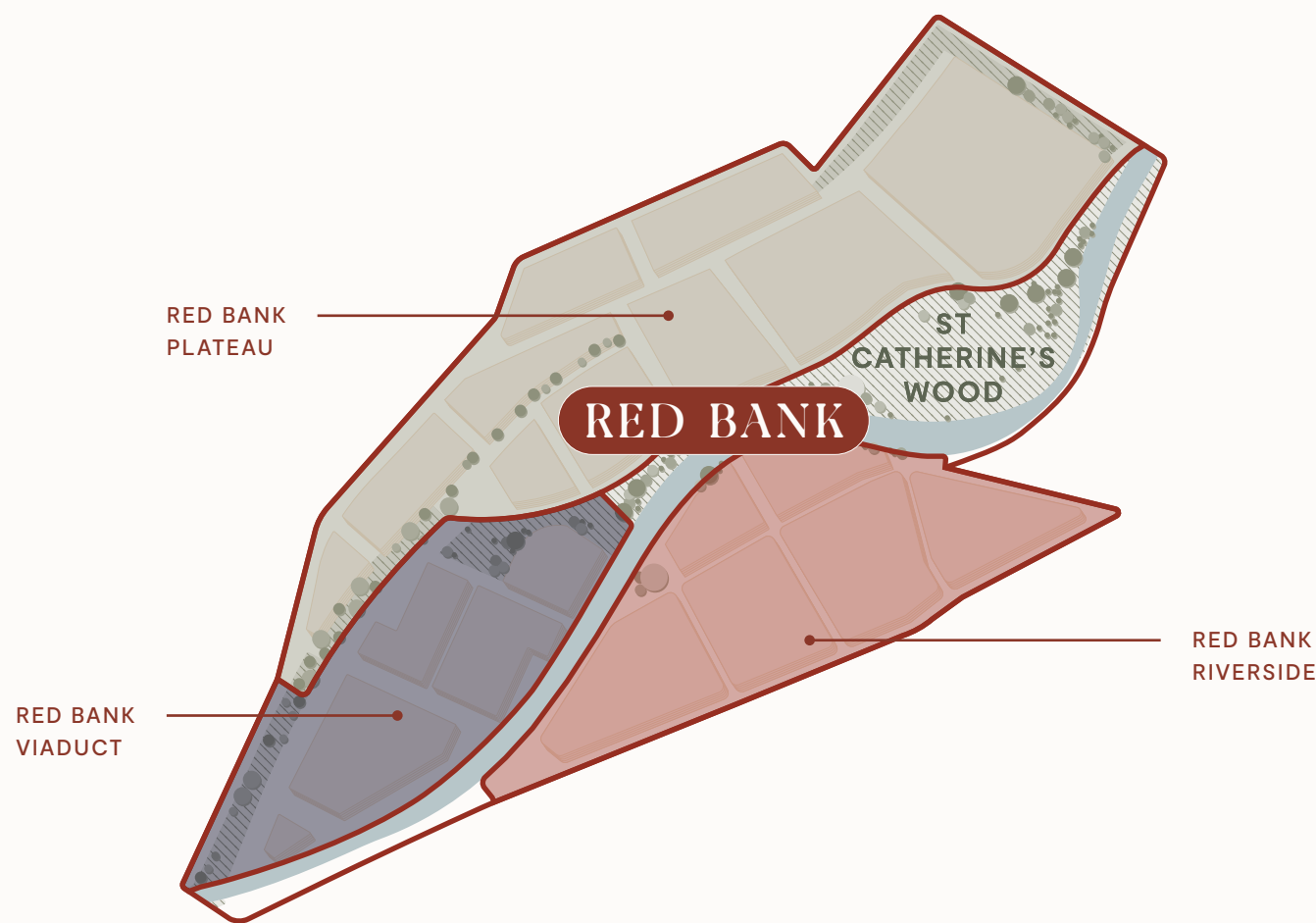

Woven into Red Bank's natural landscapes are three neighbourhoods, each with their own personality and style of living. Residents can roam between them, using lush green routes to discover the unique characteristics of each. Stop for a drink, bite and side of city charm in Red Bank Viaduct, where the city's industrial heritage meets a buzzing dining scene.

Or breathe in the panoramas of the parkland from Red Bank Plateau, its residential hum designed for exploration and family life in tune with nature. Then there's the district's thriving heart, home to Falcon: Red Bank Riverside combines the vibrant high street with calming waterside living.



Clockwise from top left: The bustling St Catherine's Square with café and play facilities, the spacious Plateau Courtyards overlooking the River Irk, looking North East towards Union Waterfront in Red Bank Viaduct, Dulwich Street in Red Bank Riverside showing public space with market stalls

170k

NEW HOMES REQUIRED

Required in Manchester by 2038
to keep pace with population and
economic growth



32%

ECONOMIC GROWTH

Over the last decade, more than
any other UK city

2.8m

GREATER MANCHESTER POPULATION

Rising by twice the national average

+19.3%

PROPERTY GROWTH

Forecast by 2027

+20.4%

RENTAL GROWTH

Average rents are increasing year-on-
year with property prices increasing
21.8% since the end of 2019

60,000

NEW JOBS CREATED

Between 2015 and 2021

Sources: JLL, Urbanbubble and Data Commons

INVEST IN MANCHESTER'S FUTURE

MANCHESTER IS ONE OF THE UK'S MOST EXCITING
INVESTMENT OPPORTUNITIES, WITH VICTORIA NORTH
LEADING THE CITY'S RESIDENTIAL RESURGENCE DRIVEN
IN PART BY ACCELERATING CORPORATE GROWTH.

NATIONAL AND INTERNATIONAL COMPANIES NEARBY INCLUDE:



The rising demand for new homes in Manchester is being fuelled by the city's growing population, all thanks to its thriving economic and social scenes. Manchester boasts one of Europe's largest student populations – over 110,000 students – impressively retaining over 60% of its graduates. This trend has attracted major national and international companies the likes of Amazon, Google and BBC.

New offices and business-centric precincts such as NOMA, a five-minute walk from Red Bank, have led to the creation of 24,000 new jobs in the professional and financial services industries between 2015 to 2021. A thriving job market means a flourishing property market, and the growth experienced in both property prices and rental rates over the past decade shows no signs of slowing down.

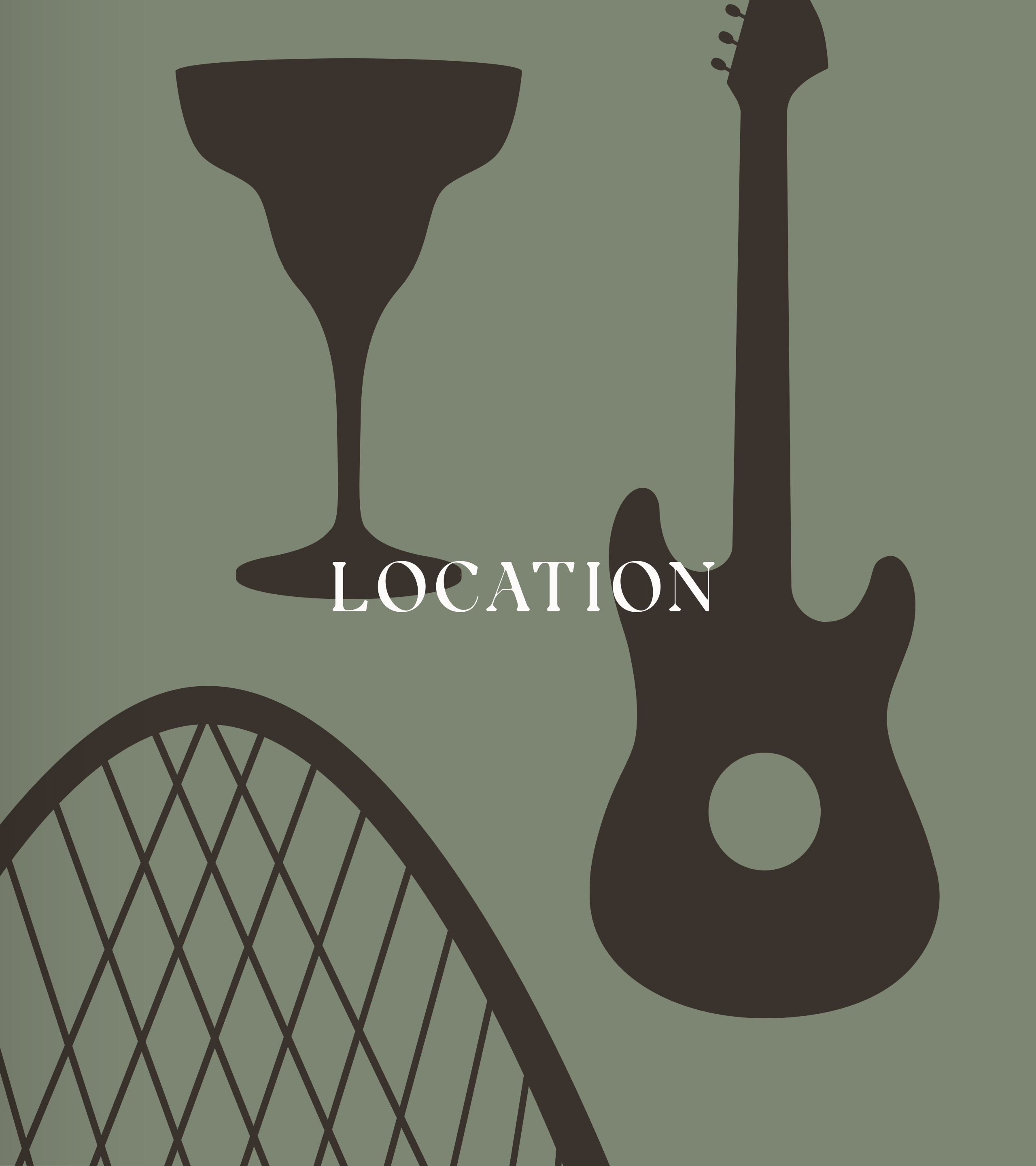

LOCATION

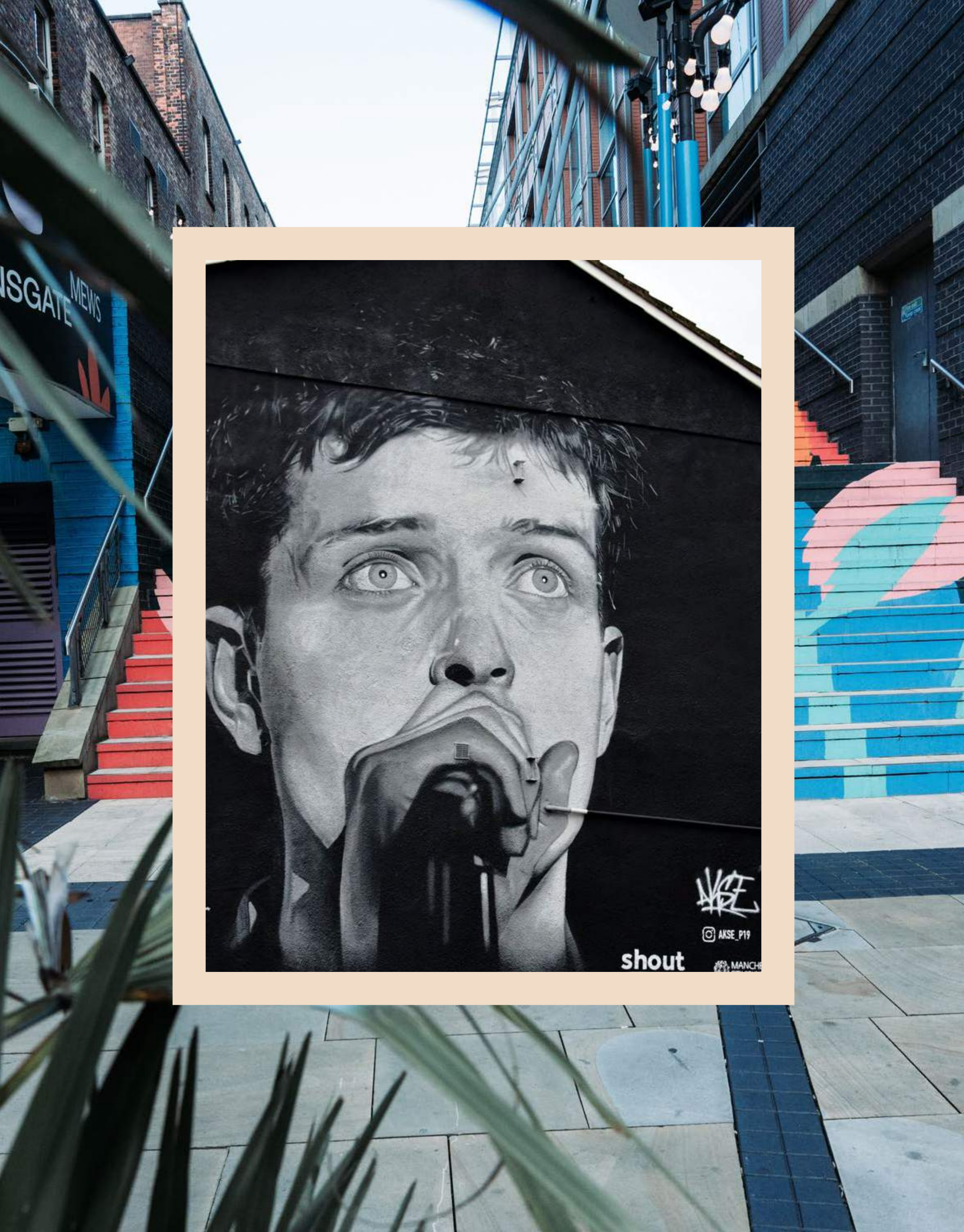

The Northern Quarter is a haven of pubs, bars and live music venues

THE UK'S CAPITAL OF
MUSIC, MANCHESTER IS A
DYNAMIC BLEND OF UPBEAT
BARS, CULT-FAVOURITE
RESTAURANTS AND LIVELY
CLUBS INTERTWINED WITH
A RICH CULTURAL SCENE OF
THEATRES AND GALLERIES.

Aviva Studios, a landmark new cultural space for Manchester!



THE CITY OF CHARACTER AND CULTURE

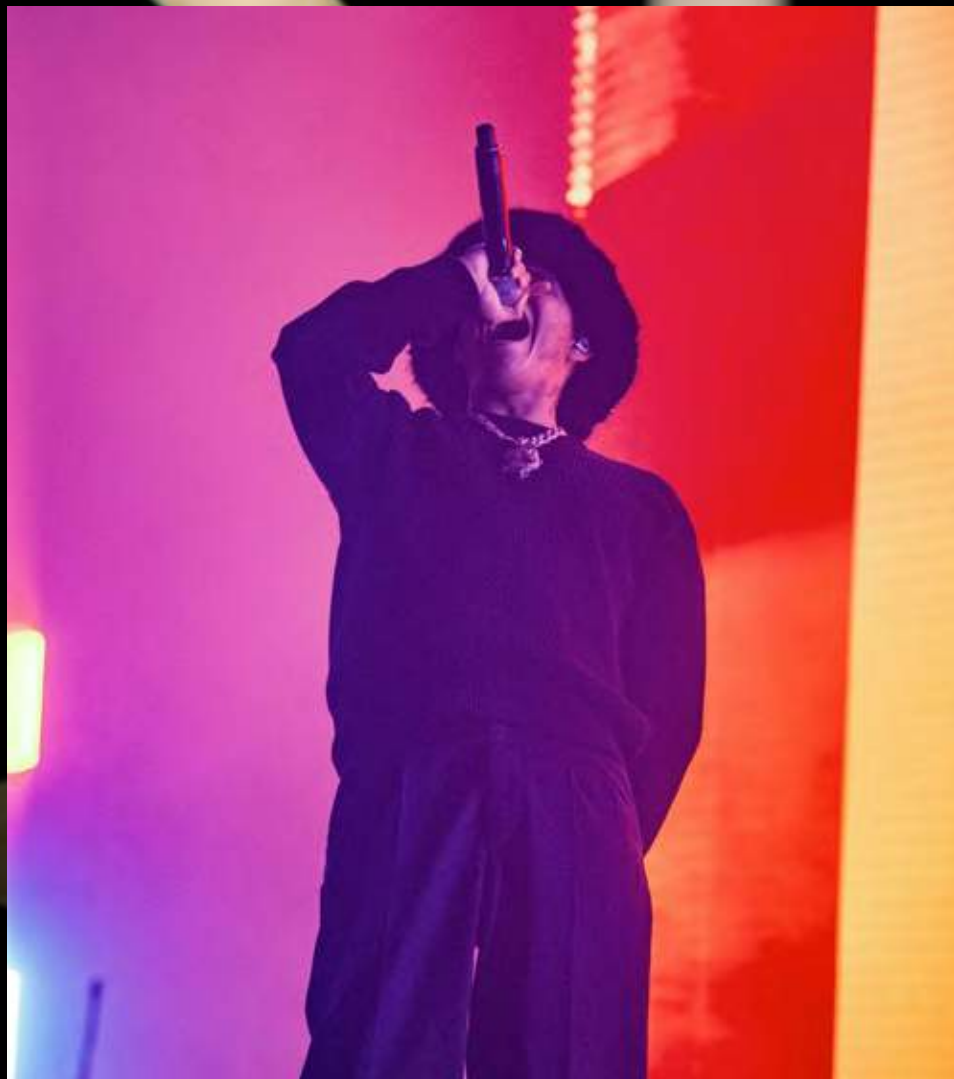

Old Trafford, home to Manchester United Football Club

A hub for the arts, Manchester has an electric atmosphere and buzzing cultural, entertainment and sports scenes. Tap into the city's unique energy whether browsing at the Arndale Centre or exploring the Northern Quarter with its vintage

shops, record stores and lively bars – think The Daisy and Behind Closed Doors. And when you're done brunching at Ezra & Gil, fine dining at Mana or catching a gig at New Century Hall? Just wander back home to Red Bank.

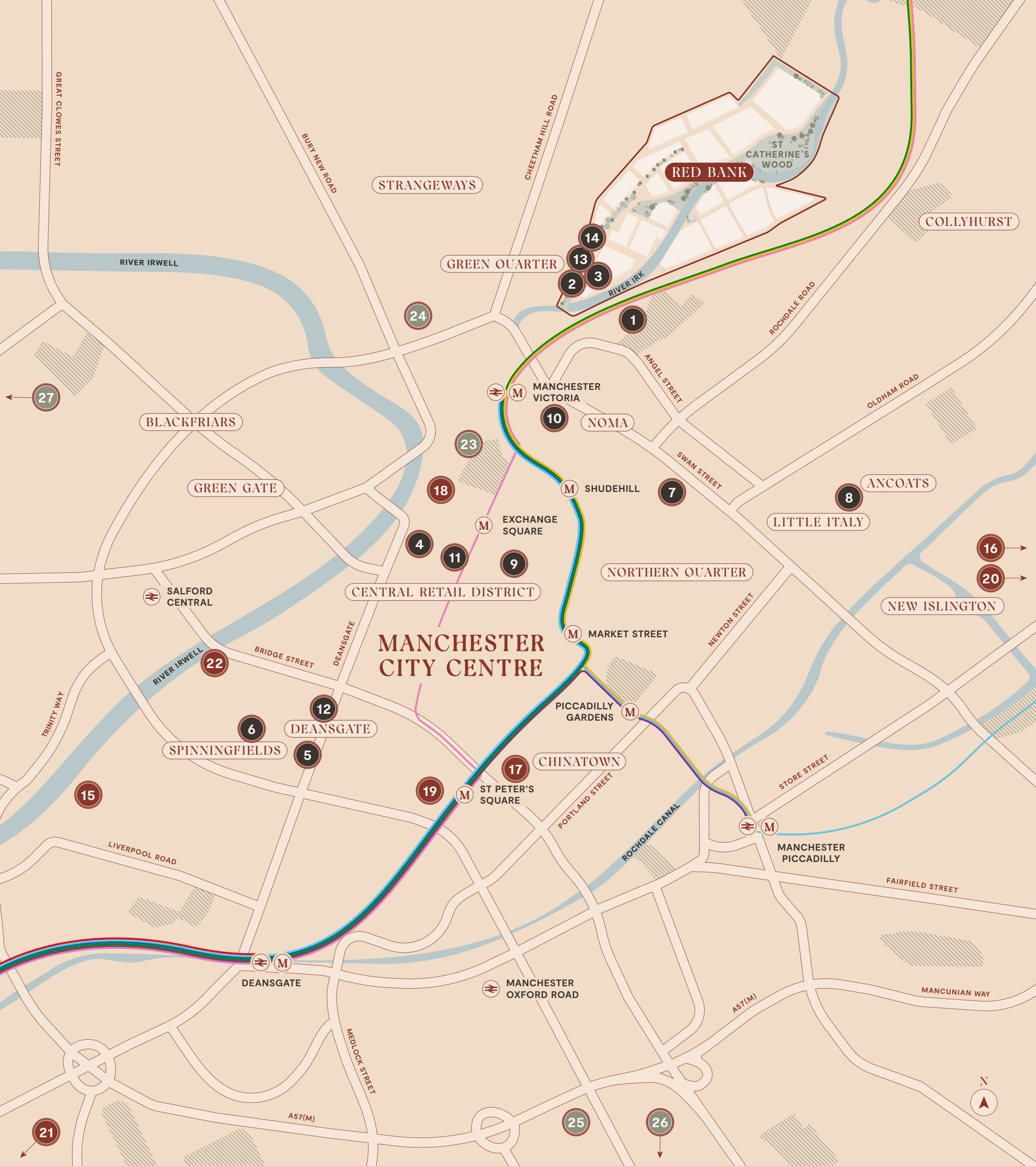

MAKE DINNER PLANS WITHOUT TRAVEL PLANS

RESTAURANTS, BARS AND RETAIL

- 1 Foundation Coffee House
- 2 Green Arches
- 3 Half Dozen Other
- 4 Harvey Nichols
- 5 Hawksmoor
- 6 The Ivy, Spinningfields
- 7 Mackie Mayor
- 8 Mana
Michelin Star
- 9 Manchester Arndale
- 10 New Century Hall
- 11 Selfridges
- 12 Sexy Fish
- 13 The Spärrs
Michelin Bib Gourmand
- 14 Suzume

CULTURE

- 15 Aviva Studios
- 16 Co-op Live Arena
- 17 Manchester Art Gallery
- 18 Manchester Cathedral
- 19 Manchester Central Library
- 20 Etihad Stadium
- 21 Old Trafford
- 22 People's History Museum

EDUCATION

- 23 Chetham's School of Music
- 24 The Manchester College
- 25 Manchester Metropolitan University
- 26 The University of Manchester
- 27 The University of Salford

SEAMLESSLY CONNECTED TO THE CITY

Red Bank’s central location and active travel routes make it effortless to stroll into town and explore different neighbourhoods. A short walk to Victoria Station connects you to the city’s extensive rail and metro systems, putting everywhere in Manchester and beyond within easy reach. Red Bank’s own attractions – from Dantzic and Dulwich Streets to its waterfront and green spaces – will see it becoming a destination in its own right.

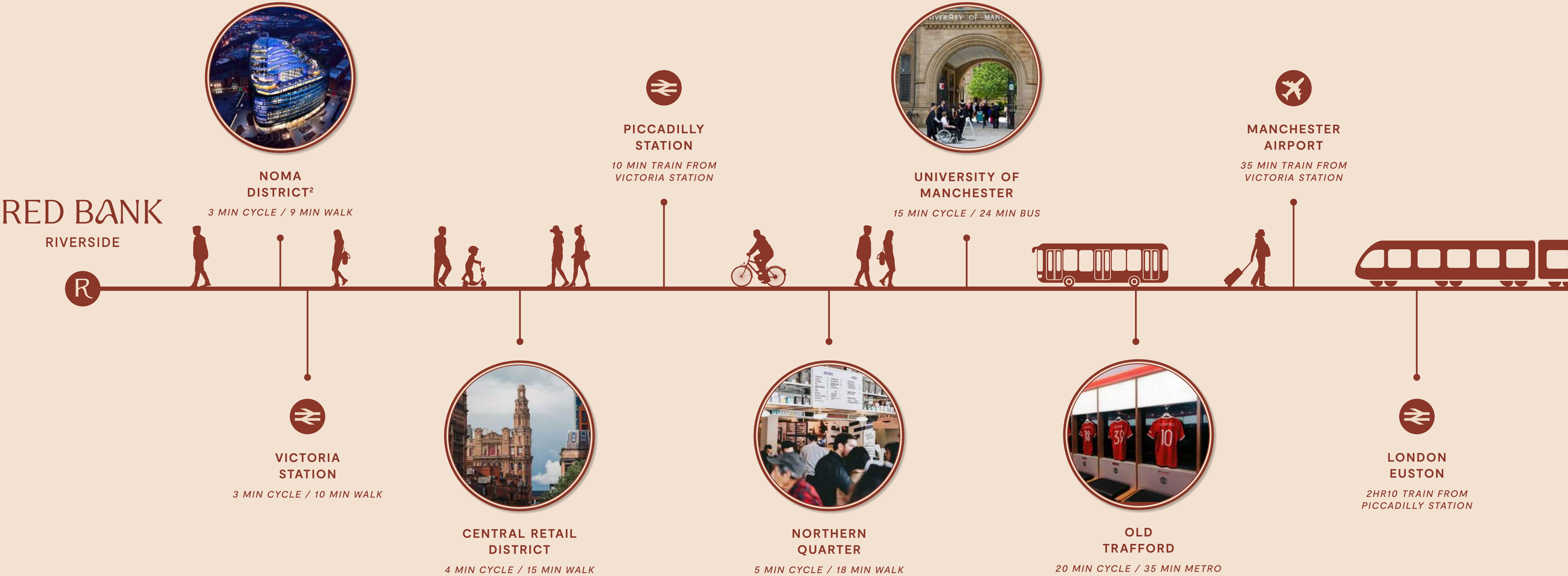

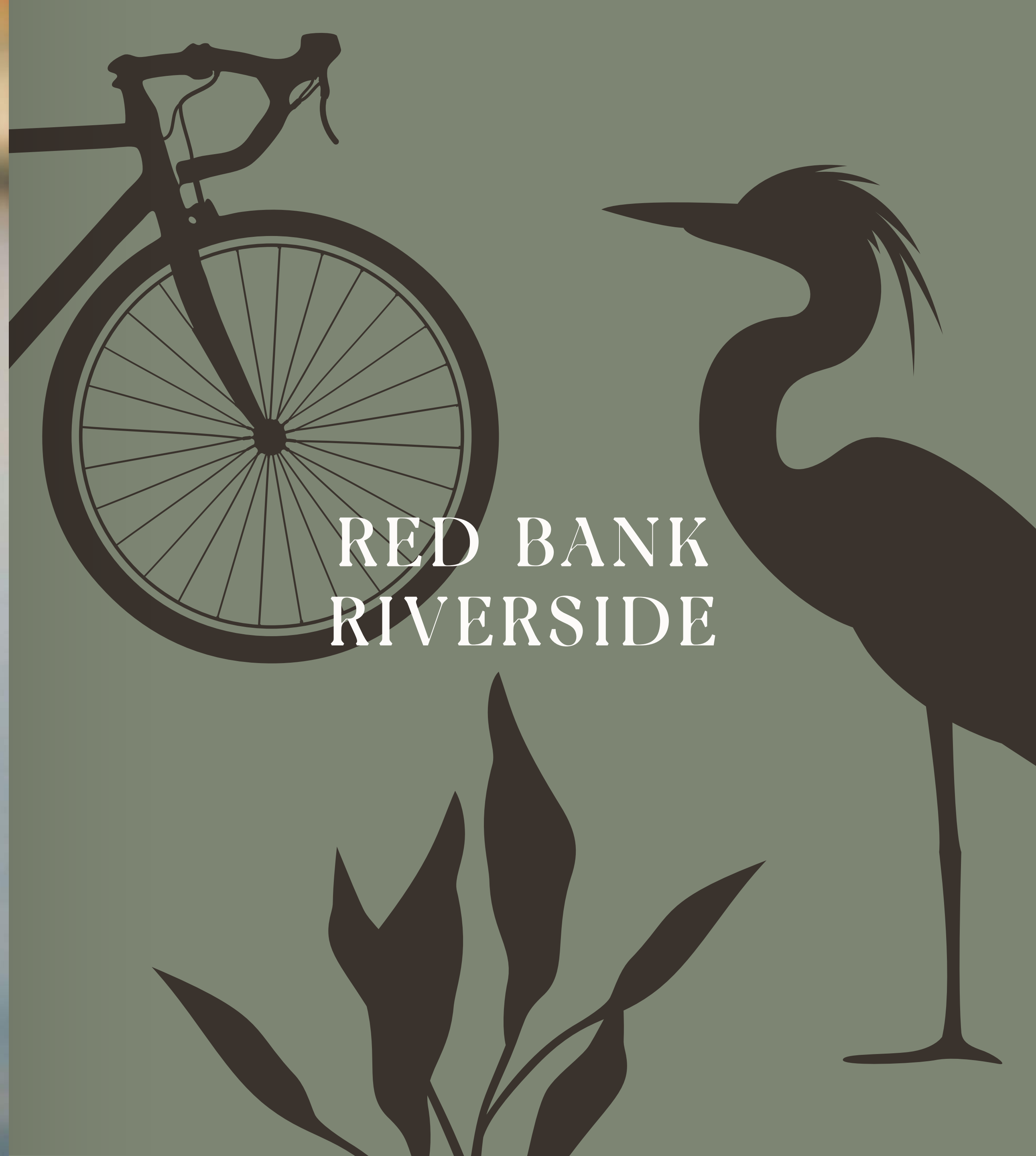

RED BANK
RIVERSIDE

FALCON



*A view of Red Bank Riverside from Red Bank Plateau,
including Victoria Riverside to the right, due for completion by 2025*

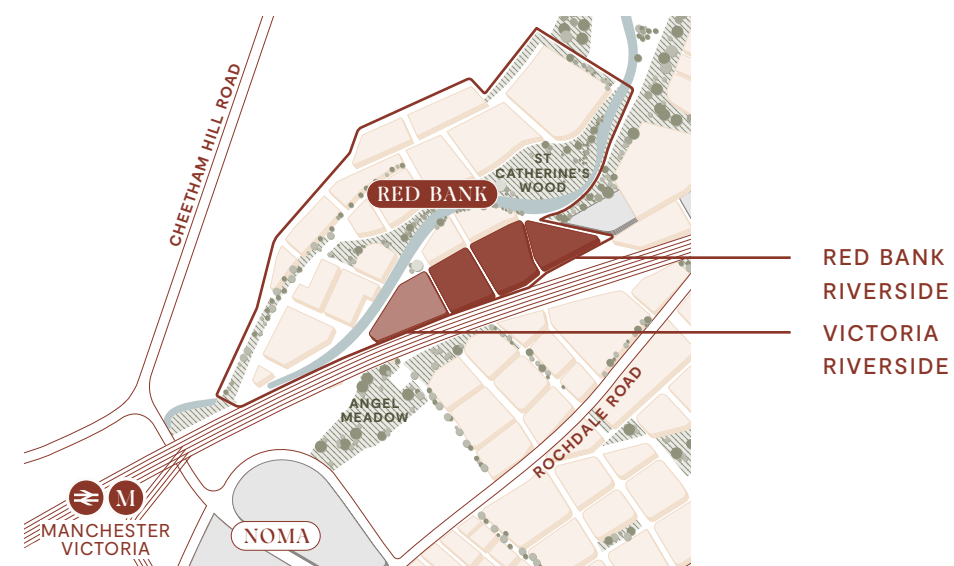

Located between Dantzic Street and Dulwich Street, Falcon shares generous open-air green and social spaces with its neighbouring towers. The public realm has been designed for outdoor living, with integrated seating and flexible-use areas for pop-up markets, alfresco fitness sessions or music and dining events.

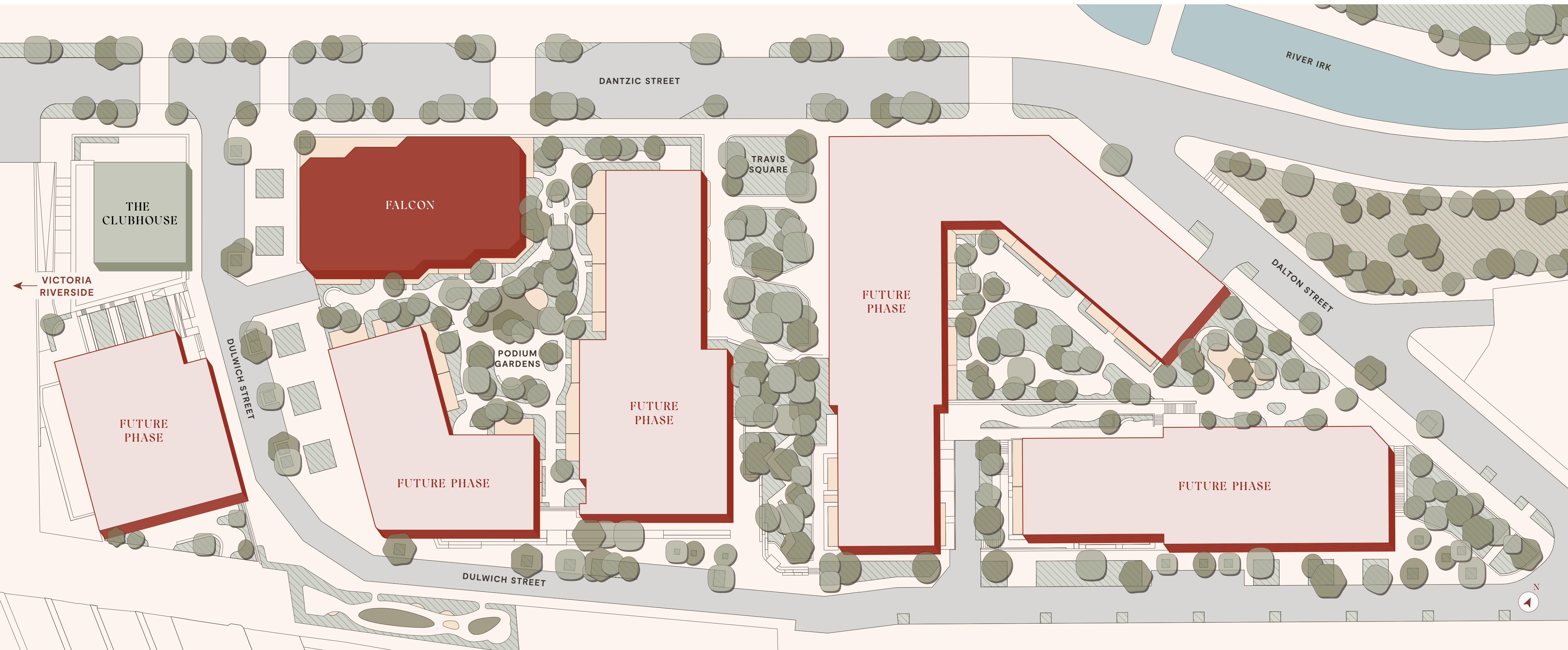

THE HIGH STREET ON YOUR DOORSTEP



Dantzic Street is Red Bank's nature-fringed high street, putting supermarkets, pharmacies and day-to-day essentials within easy reach. Pedestrian friendly, with wide pavements, it is also a social hub, full of familiar faces and a place for neighbours to come together.

Pick up a coffee and still-warm croissant from the bakery on your way in to work. Tick off your to-do list then grab a bite in your favourite café. Meeting for birthday drinks and forgot to buy a gift? Just get one on the way.



Falcon entrance at the junction of Dulwich and Dantzic Street

TAKE A WALK ON THE GREENER SIDE OF MANCHESTER

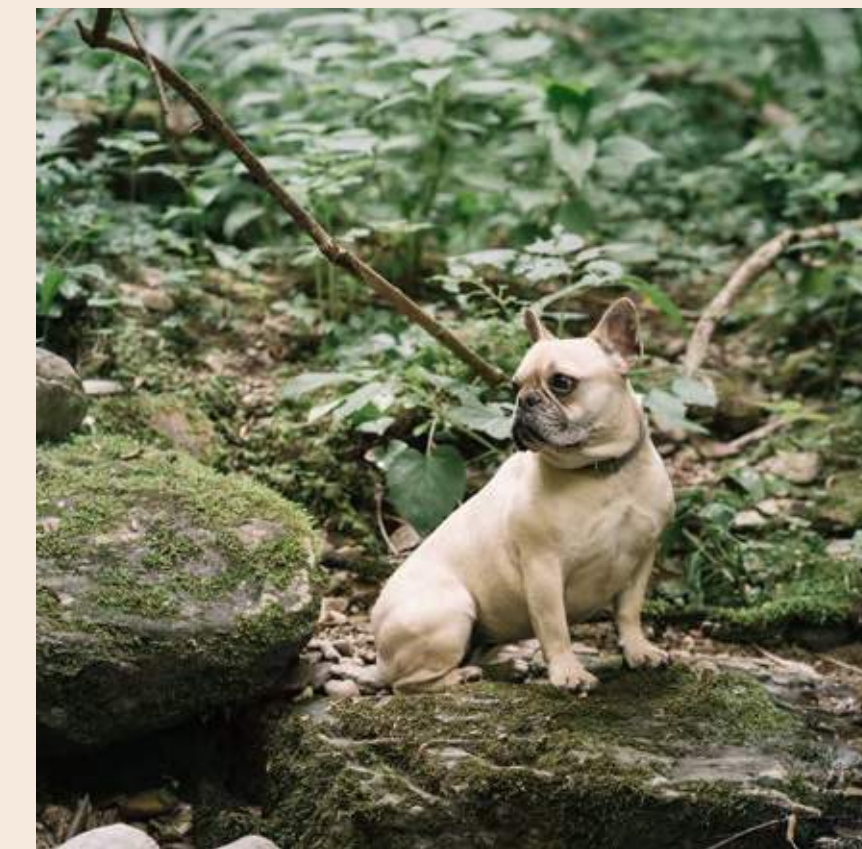

The City River Park introduces Manchester's most extensive natural asset, greening over 46 hectares along the River Irk. Proposed as the largest park in Manchester, it will provide a diverse and active new recreational corridor linking parks from Angel Meadow through St Catherine's Wood – the UK's first urban woodland – all the way to Queen's Park in the north.

Falcon connects to this natural haven via Red Bank Riverside's 1.5km Climate Loop of walking and cycling routes. Enjoy an active lifestyle as you discover the new highline and follow meandering forest pathways to discover areas to play and explore. Guided by climate positive design, existing habitats have been enhanced and new ones created for the benefit of all.

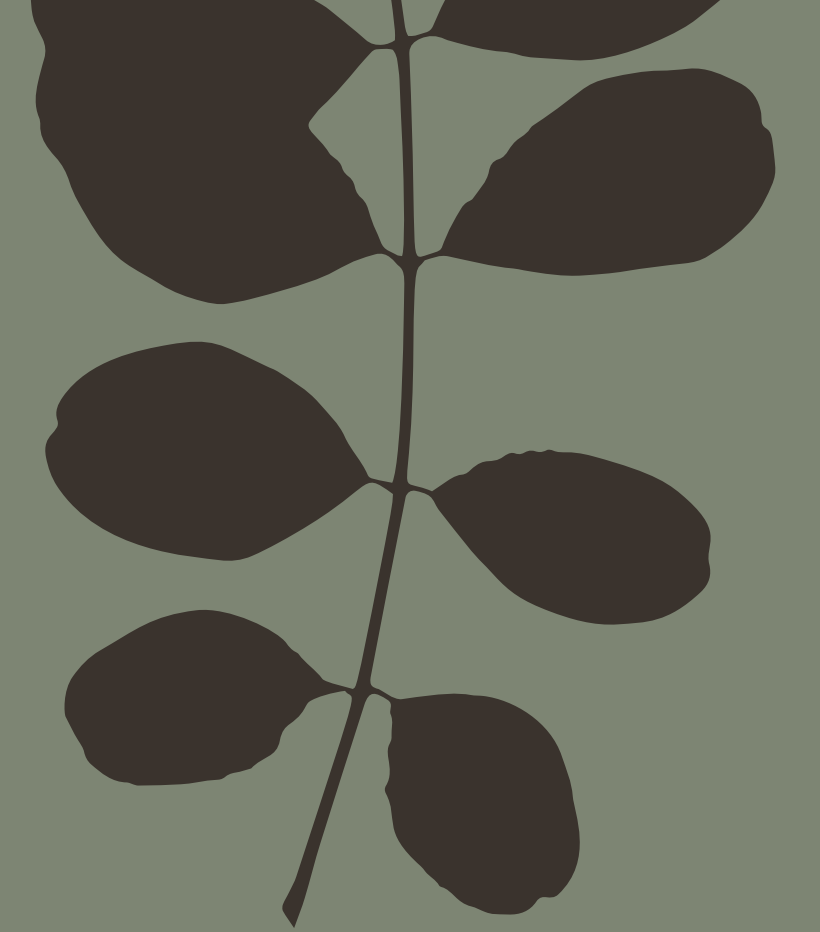

AMENITIES





WELCOME TO THE CLUB



BAR & RESTAURANT

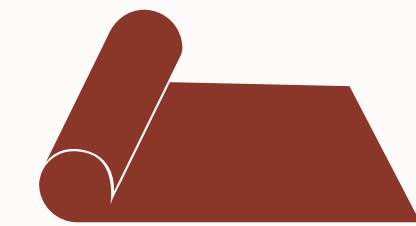

FITNESS & WELLNESS
SUITE

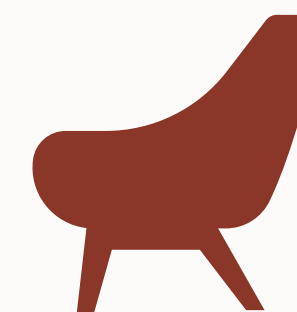

RESIDENT'S LOUNGE



PRIVATE HIRE DINING SPACE



CO-WORKING SPACE

Who knew balance was so easy to find? Right next door to Falcon is the residents' Clubhouse which caters to every wellness, working and social need. Want to work up a sweat? The fitness suite has you covered. Deadline to meet? Co-working facilities are fully equipped

to help you nail that pitch. Desperate for down time? Escape to the wellness suite for some much needed quiet respite. And in between, on special occasions and every day, the lively bar and restaurant will ensure you're refuelled and reconnected.



A warm welcome at the Clubhouse reception



WORK, CREATE, CONNECT.

The tech-enabled co-working space includes meeting rooms and tucked-away huddles for solo or collaborative work.

**LIVE STRONGER.
LIVE BETTER.**

Achieve your wellness goals with the fitness suite's comprehensive cardio and weight equipment, movement studio for yoga and Pilates, and juice bar for post-workout socialising.





Bar & restaurant in the Clubhouse



YOUR CITY HOME. YOUR NATURAL RETREAT.

Falcon residents have access to podium gardens shared by the surrounding towers. Landscaping is wild-oriented, creating glade-like spaces in which residents can relax and socialise.



The podium gardens put an elevated green oasis right on Falcon's doorstep

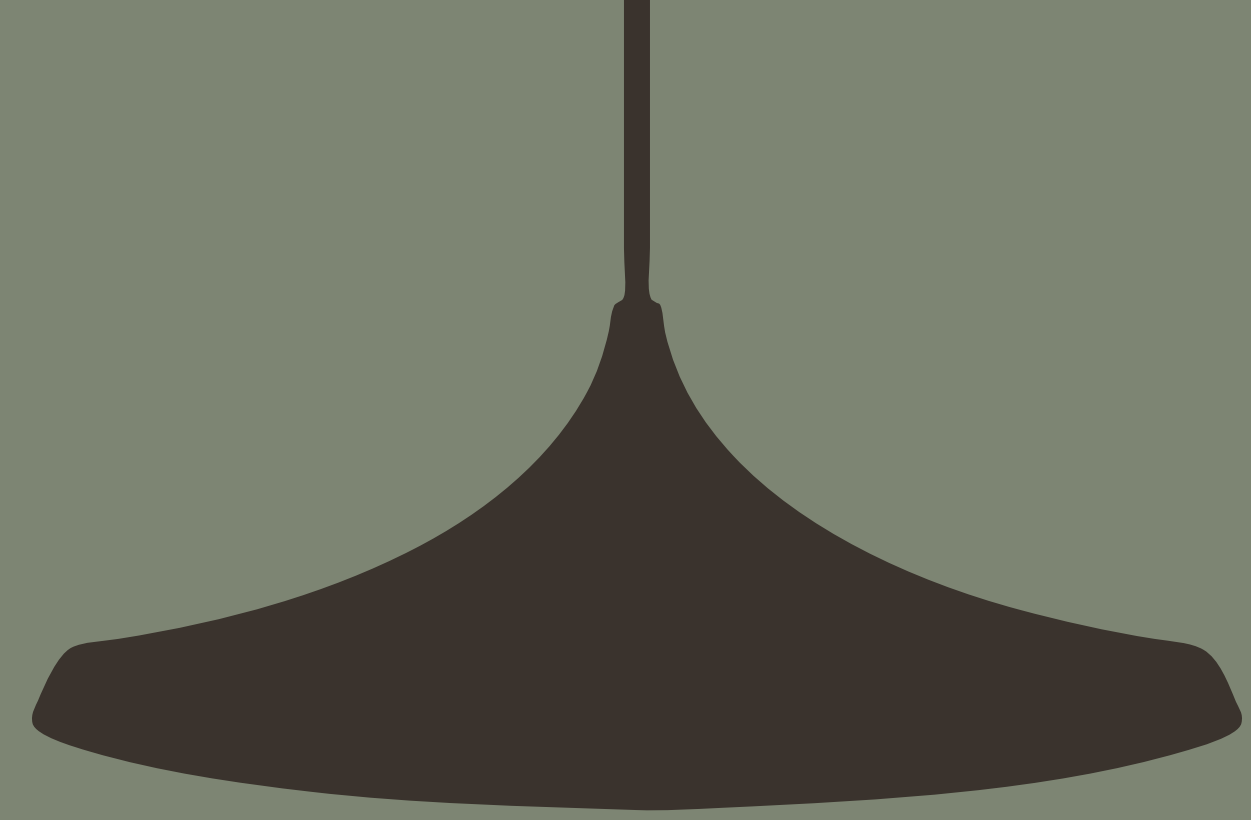

APARTMENTS





OPEN PLAN LIVING
FOR A MODERN
LIFESTYLE.

Living spaces offer contemporary finishes
in a neutral palette to allow residents to
make the space their own.





**AN URBAN
SANCTUARY.
CRAFTED FOR
COMFORT.**

Generously proportioned double bedrooms with floor-to-ceiling windows welcome in natural light throughout the day.



SPECIFICATION

GENERAL

- Generous floor-to-ceiling window to each living space and bedroom
- Majority apartments featuring dual aspect views
- All apartments are mechanically ventilated with MVHR units
- Natural ventilation provided through full height perforated panels which allows fresh air into the apartment

ENTRANCE AREA

- Video door entry system
- Spy hole to apartment front door
- Solid core entrance door with multipoint locking system
- Storage cupboard

LIVING AREA

- Open plan living area
- Recessed LED lighting
- Full height feature floor-to-ceiling window
- Opening door vents with perforated safety panels which allows fresh air into the apartment
- Telephone and TV Point to living area

KITCHENS

- Fully fitted base and wall mounted units with handle-less doors and soft closing hinges
- Full height splashback to underside of cupboard
- Solid surface worktop (*Sile stone or similar*)
- Stainless steel sink with chrome finish mixer tap
- Concealed LED lights below wall mounted units
- Integrated electric oven and hob with extractor hood (*Bosch or similar*)
- Integrated dishwasher (*Bosch or similar*)
- Integrated fridge/freezer (*Bosch or similar*)
- Freestanding washer dryer in utility cupboard (*Bosch or similar*)

BATHROOMS

- Contemporary white steel enamel bath with fitted shower above bath and glass shower screen
- White ceramic wall mounted WC with concealed cistern
- White ceramic wash hand basin with chrome finish mixer tap
- Heated towel rail
- Fully tiled floors and walls
- Recessed LED spot lighting
- Shaver point
- Mirrored cabinet with lighting above sink

EN SUITES

- Walk in shower with toughened glazed opening door
- Fitted chrome shower
- White ceramic WC with concealed cistern
- White ceramic wash hand basin with chrome finish mixer tap
- Heated towel rail
- Fully tiled floors and walls
- Recessed LED spot lighting
- Shaver point
- Mirrored cabinet with lighting above sink

FLOORING AND DOORS

- Tiled flooring to bathrooms
- Laminate wood flooring to kitchen, living room, bedrooms
- Solid core internal doors

HEATING

- Mechanical ventilation and heat recovery system
- Wall mounted electric panel radiators
- Air Source Heat Pump cylinder for hot water

A TRUSTED INTERNATIONAL DEVELOPER



WITH PRESENCE IN CHINA, HONG KONG, MALAYSIA,
SINGAPORE, AUSTRALIA, NEW ZEALAND, MAINLAND
EUROPE AND THE UK, FEC BRING THEIR EXTENSIVE RANGE
OF EXPERIENCE TO MANCHESTER'S VICTORIA NORTH

Far East Consortium International Ltd (FEC) is a leading property group specialising in property development and hospitality across the globe. Listed on the Hong Kong stock exchange since 1972, the company opened its UK head office in London in 2011 and a regional office in Manchester in 2016.

Bringing over 50 years of experience to the Victoria North regeneration, FEC have already delivered several successful Manchester-based schemes including Meadowside and New Cross Central. Projects currently in development include Victoria Riverside, Collyhurst Village, and Consort Place in London.



Clockwise from top left: Victoria Riverside, Manchester UK, Elizabeth Quay, Perth Australia, and Consort Place, London UK

CONTACT OUR SALES TEAM

ENQUIRIES @ FIRST-IP.COM

+ 8 5 2 2 3 8 3 8 9 9 2

ADDRESS

HOMES BY FEC MARKETING SUITE
19 ASPIN LANE, MANCHESTER, M4 4DP

Homes by



FIND OUT MORE

REDBANKRIVERSIDE.CO.UK/FALCON

RED BANK
RIVERSIDE

Disclaimer: Northern Gateway (FEC) No.11 Ltd assumes no responsibility and shall not be liable to any person for any loss, damage or expense caused by reliance on the information in this brochure. Northern Gateway (FEC) No.11 Ltd is appointed development manager of Red Bank Riverside. Whilst reasonable efforts have been made to ensure that the information in this brochure is correct, it is designed specifically as a broad indicative guide only and Northern Gateway (FEC) No.11 reserves the right to amend any of the specifications at its absolute discretion as necessary and without any notice. This brochure does not in any way constitute or form any part of a contract for sale, transfer or lease nor does it constitute a representation or otherwise form the basis of a contract. Photography taken at similar Far East Consortium developments and computer-generated images (CGIs) are indicative only and should not be relied upon as depicting the final as built development or apartment. Prospective purchasers should satisfy themselves regarding the accuracy of the information provided in this brochure. No assumption should be made regarding any part or the whole of any plot or the estate not shown in the brochure. January 2024. ¹Marco Cappelletti, courtesy of OMA and Factory International. ²Trevor Palin, 2012. One Angel Square during night.